

SEF/EAC– July 2024

Corporate Services Division

Samantha Kuula
Director





- *Site Access*
- *EHS STMS*
- *Cyber Event*
- *EDI support*



Handbooks

ZES Training

CAR Training

Group Training

Register

Login

Welcome to Vale's Learning & Development orientation portal.

Full access to all training modules anytime and anywhere.



Welcome to the SNOLAB Safety Training Management (STMS) Portal.

Here, you can:

- Request for the EHS trainings as per SNOLAB EHS Training Matrix.
- Supervisors can view, download the training reports for their team.
- Upload EHS training Records/Documents.
- EHS-Training Coordinator will review and audit EHS training records of the personnel upon completion of those trainings.

For any questions or concerns please reach us at EHS-Training@snolab.ca

Important Links

My Training Dashboard	Request Training	Search Training...	Expiring Trainings	Registration

SNOLAB New User Onboarding Process Flow

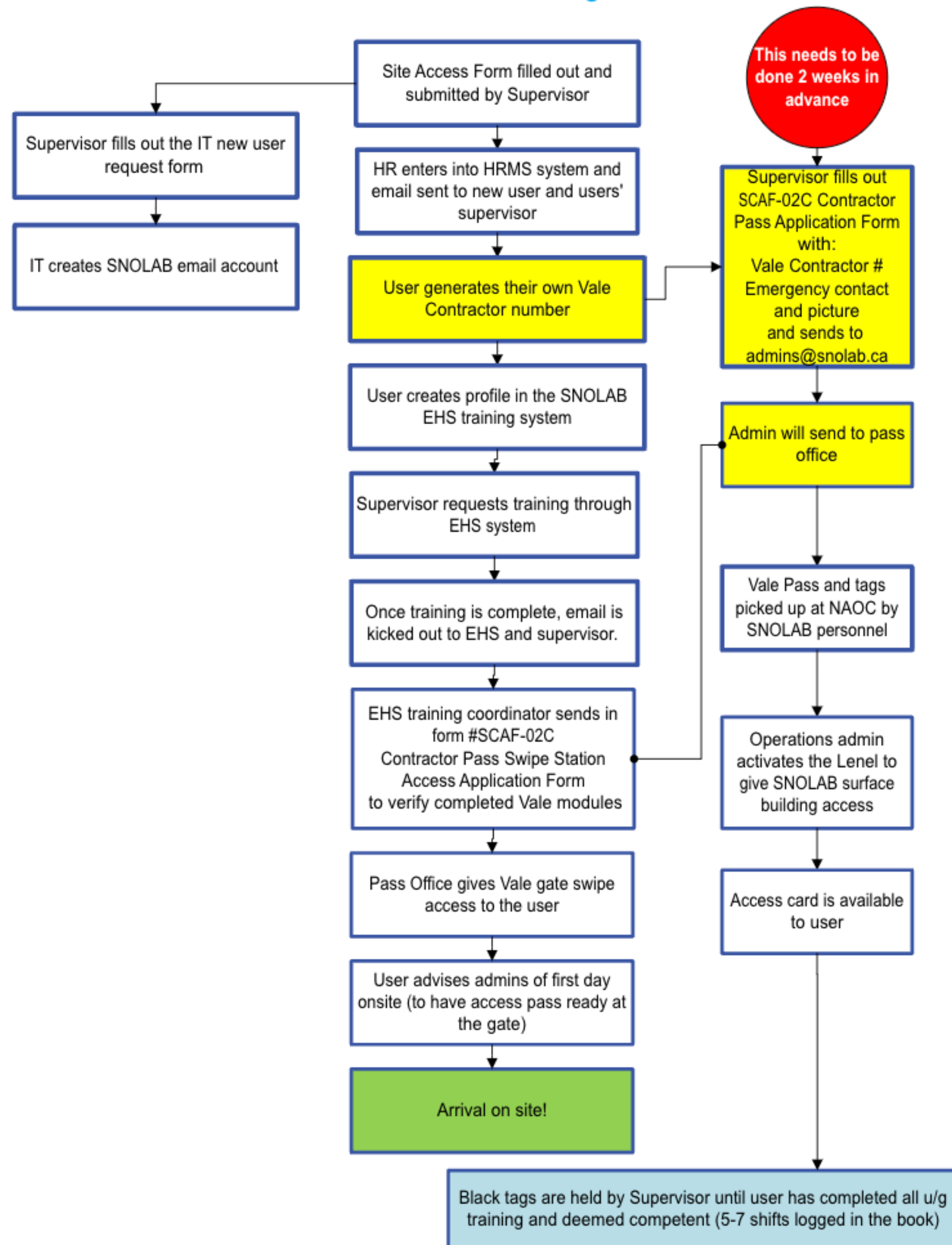

Highlights

- Paperwork must be submitted 2 weeks prior to arrival on site
- Vale is enforcing “No pass, No access”
- There are new training requirements to access site (CAR, Environmental)
- All vehicles driven through the gate to the SNOLAB building must have a Vehicles Contractor Pass.

Docushare

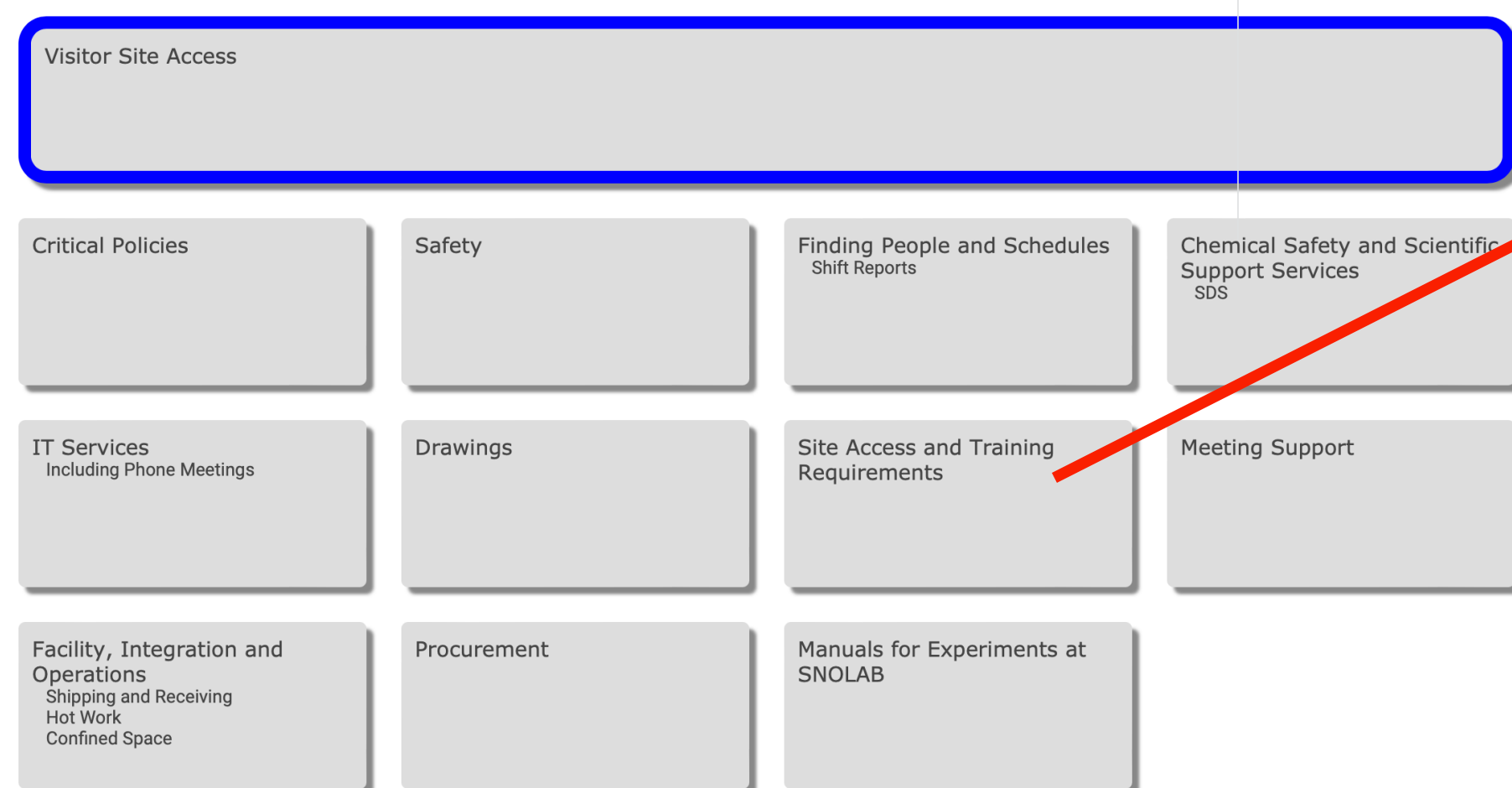

A screenshot of the Docushare interface. A tooltip is open over the "Site Access and Training Requirements" menu item. The tooltip contains the following text:

- Site Access Policy and Forms (Now found in Outreach)
- New EHS Training Link
- SNOLAB EHS Training Matrix
- EHS Training Procedure
- Self-Contained Self-Rescuer (SCSR) Manuals
- Site Access Form
- Contractor Pass Swipe Station Access Application
- Contractor Pass Profile Application - Group or Single
- Vale Application for Contractor Vehicle Pass

The background interface shows a grid of menu items: "Visitor Site Access" (highlighted with a blue border), "Critical Policies", "Safety", "IT Services Including Phone Meetings", "Drawings", "Facility, Integration and Operations Shipping and Receiving Hot Work Confined Space", "Procurement", and "Manuals for Experiments at SNOLAB".

SNOLAB Users Sharepoint



SNOLAB Users and Students (SUS)

SNOLAB ORIENTATION GUIDE Revised: June 18, 2024

Introduction	2
Vision, mission, and values of SNOLAB	3
SNOLAB Code of Conduct	3
Equity, Diversity, and Inclusion	4
SNOLAB EDI Committee	4
Accessibility	4
People at SNOLAB	5
Users/Visiting Scientists	5
SNOLAB Facilities	5
Surface building	6
Underground Campus	7
Laurentian University office and lab spaces	8
Getting set up onsite (Staff, students, users)	8
Site Access	8
Pedestrian walkways	9
Parking	10
Training Requirements	10
PPE Requirements	10
IT	10
IT Support	11
VPN	11
Printers	11
AV	11
SNOLAB Style Guide	11

Orientation Guide

Training

EDI @ SNOLAB

Sudbury Life

For fun



Why this Change ?

Our previous system limitations

- HRMS-Not a **safety training management system**, challenges with record keeping and tracking the trainings.
- **Limited visibility to Supervisors**- depending on whose name is captured in system in HRMS as Supervisor.
- **Safety training compliance & Audit** – EHS or Supervisors couldn't perform spot audit to check the individuals training status. Ineffective system to monitor compliance
- **Manual data update**- EHS training coordinator had to update training data manually.
- **Communication**- EHS training coordinator wasn't getting the feedback about training completion
- **Records Management**- If proof of completion not provided to EHS training coordinator, they won't update the training.
- **Tracking of training status**
- Lots of concerns raised about **visibility and transparency**
- HRMS and our previous SharePoint based system (developed in rush when COVID started) **were not integrated**.

Features of STMS

- SharePoint based system
- Designed and Developed with Internal resources
- Centralized system
- Accessing the new system:
 - <https://snolab.sharepoint.com/sites/EHSTraining/>
 - Link provided on the Docushare as well.
 - You need SNOLAB account to access this system.
 - You will have access to : Registration, My Training dashboard, Request training, Search training, Expiring Training, General safety, upcoming training, FAQs
 - System admins will have access to few other apps-Training approval/rejection, Edit Profile, Edit Training apps.
 - System generated notifications to individual, supervisor, site contact per training status.

SNOLAB SharePoint

STMS (Safety Training Management System) Home Trainings Admin

Published 6/19/2024

Welcome to the SNOLAB Safety Training Management (STMS) Portal.

Here, you can:

- Request for the EHS trainings as per SNOLAB EHS Training Matrix.
- Supervisors can view, download the training reports for their team.
- Upload EHS training Records/Documents.
- EHS-Training Coordinator will review and audit EHS training records of the personnel upon completion of those trainings.

For any questions or concerns please reach us at EHS-Training@snolab.ca

Important Links

- My Training Dashboard
- Request Training
- Search Training...
- Expiring Trainings
- Registration

Extra

- Upcoming Trainings...
- General Safety Awareness
- Training Exemption
- Announcement
- FAQ

[Feedback Form.](#)

[EHS Training Matrix](#)

[Report Event \(SNOLAB Event Reporting System\)](#)

Cyberincidents



Cyber Security Incident Report:

DDoS Attack on March 13th 2024

Executive Summary

- Date of the beginning of the incident: March 13th 2024
- Date the incident was resolved: March 15th 2024
- Systems Affected: Network Connectivity
- Type of Attack: Outbound Network Traffic was more than our Firewall could manage.
- Immediate Response: Worked with our Partner's ORION and HAXXESS to make changes to our Firewall and VPN configurations and blocked a very large amount of destination IPS as per ORION's direction.

Cyber Security Incident Report:

DDoS Attack on April 4th 2024

Executive Summary

- Date of Incident: April 4th
- Systems Affected: SNOLAB Site Internet Traffic, ability to VPN into SNOLAB
- Type of Attack: Distributed Denial of Service (DDOS) facilitated through Command and Control (C&C) Server
- Immediate Response: Isolation of affected system, blocking of IP ranges, initiation of forensic analysis

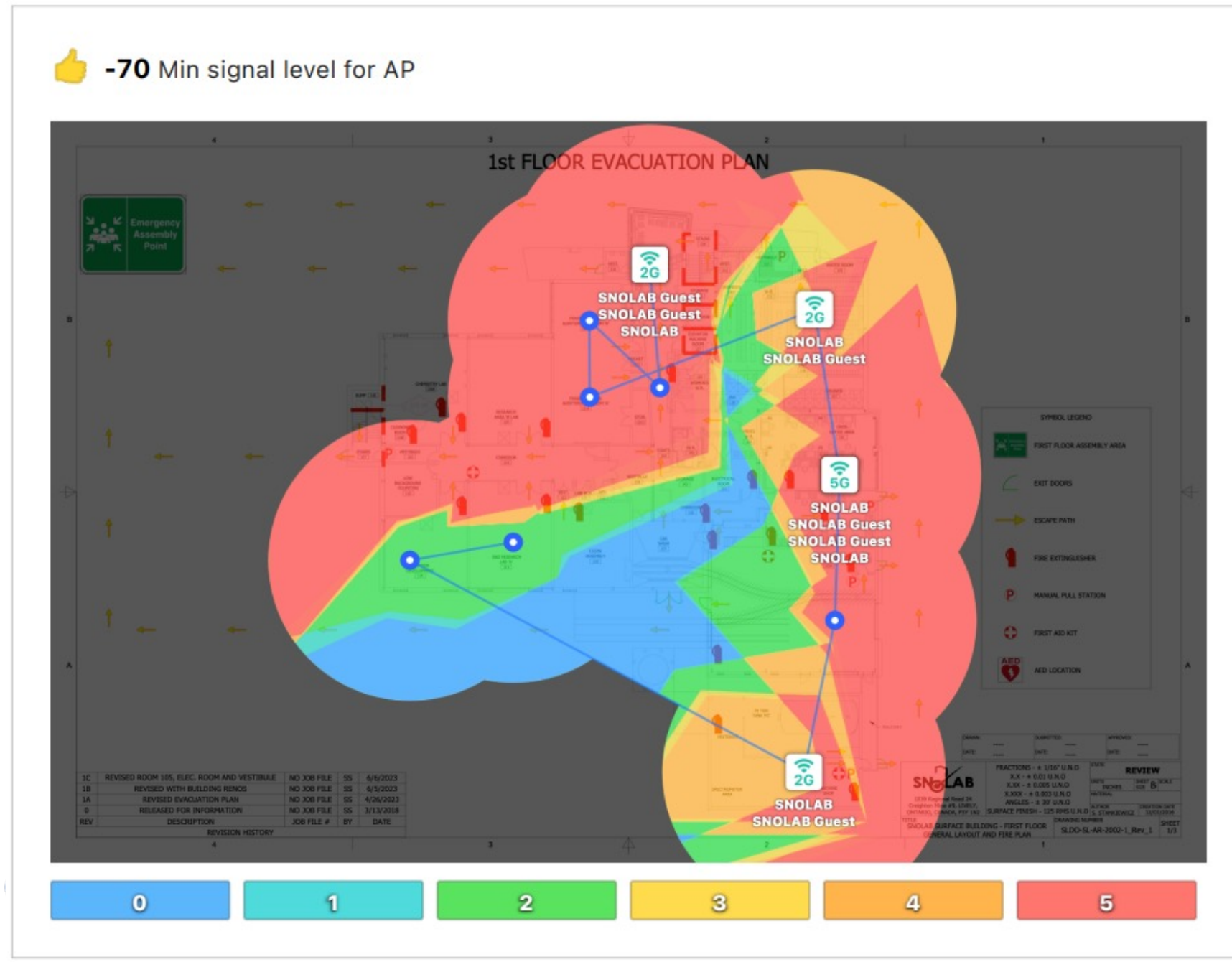
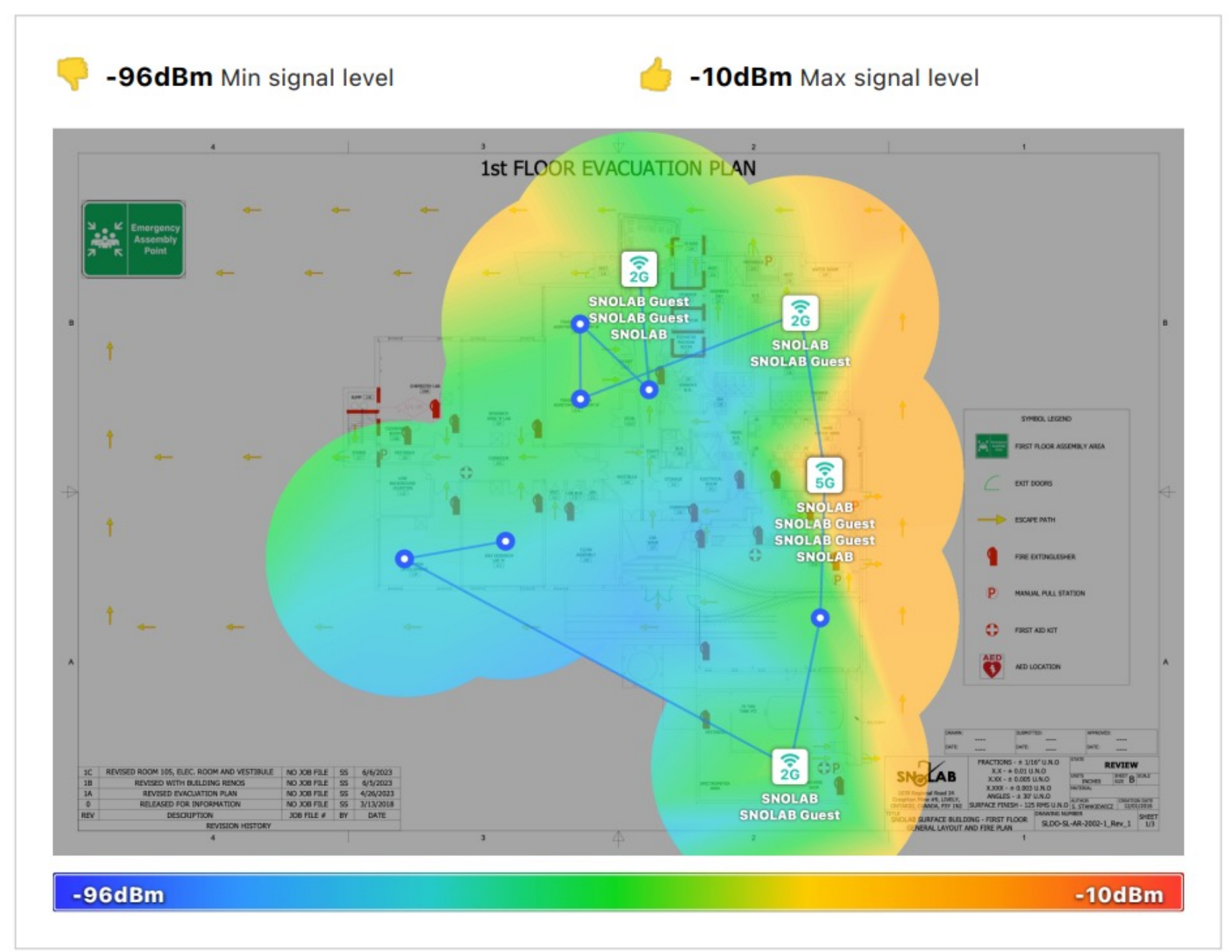
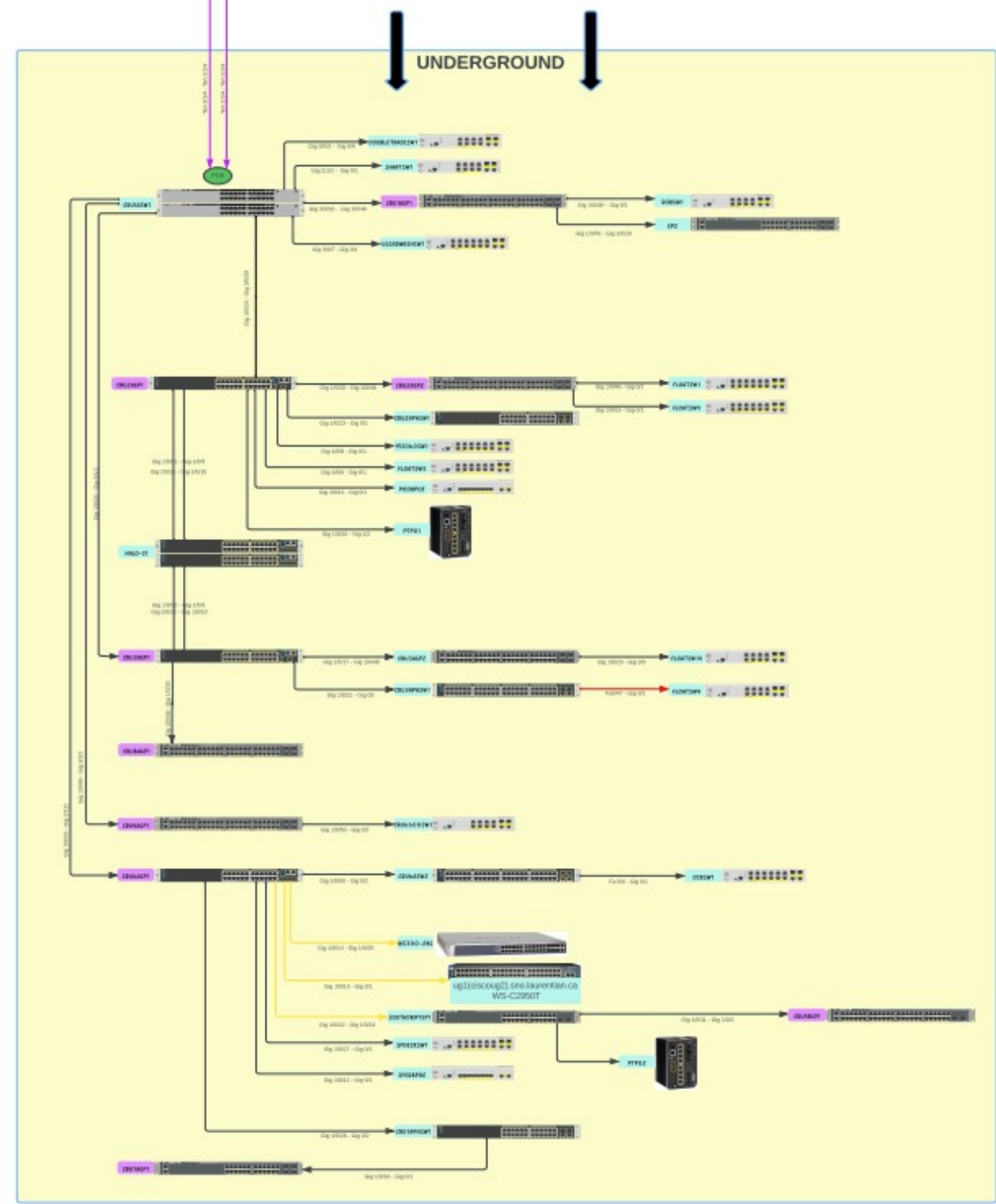
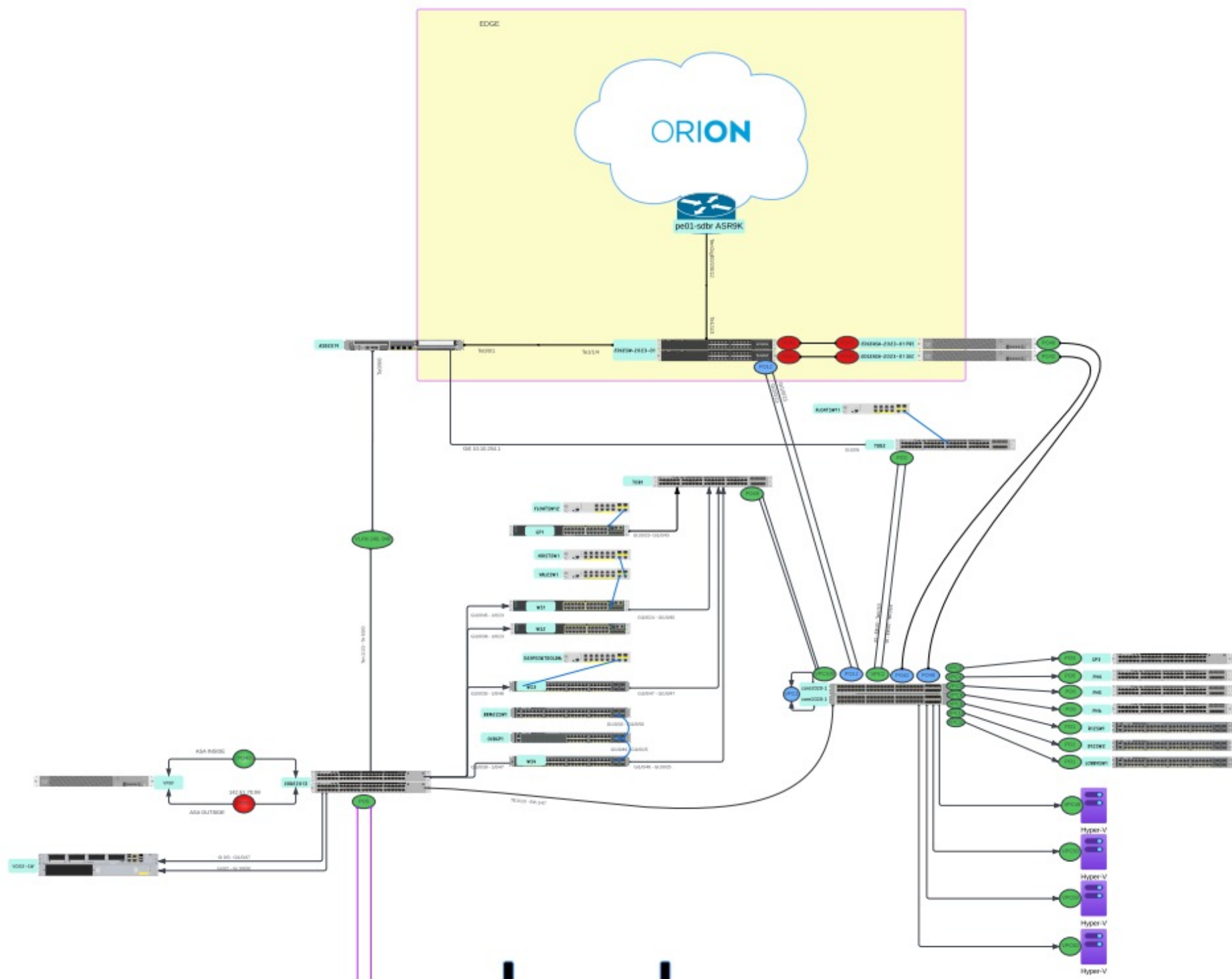

EDI Support



SNOLAB Project Lifecycle Management Guidance for new Equity, Diversity, and Inclusion Review Charge Questions

Introduction

SNOLAB strives to foster an environment where everyone feels safe, comfortable and empowered. To achieve this, SNOLAB assembled an Equity, Diversity, and Inclusion (EDI) task force comprising of various members of SNOLAB staff. In 2021, an Action Plan was created with a variety of deliverables which have either been fully implemented or is in the process of being implemented. In 2022, the SNOLAB Director of Projects began embedding within its project lifecycle reviews a charge question set to establish whether experiments were satisfactorily applying EDI measures within their collaborations.

SNOLAB Project Reviews - EDI Charge Question: *“Does the project have a suitable code of conduct and EDI strategy aligned with SNOLAB requirements and is there data on the performance of the EDI strategy.”*

1. Qualtrics survey support
2. Project Lifecycle support
3. Knowledge keeper in house
4. LinkedIn Learning
5. EDI Committee